

VS-H20 series industrial endoscope product specification

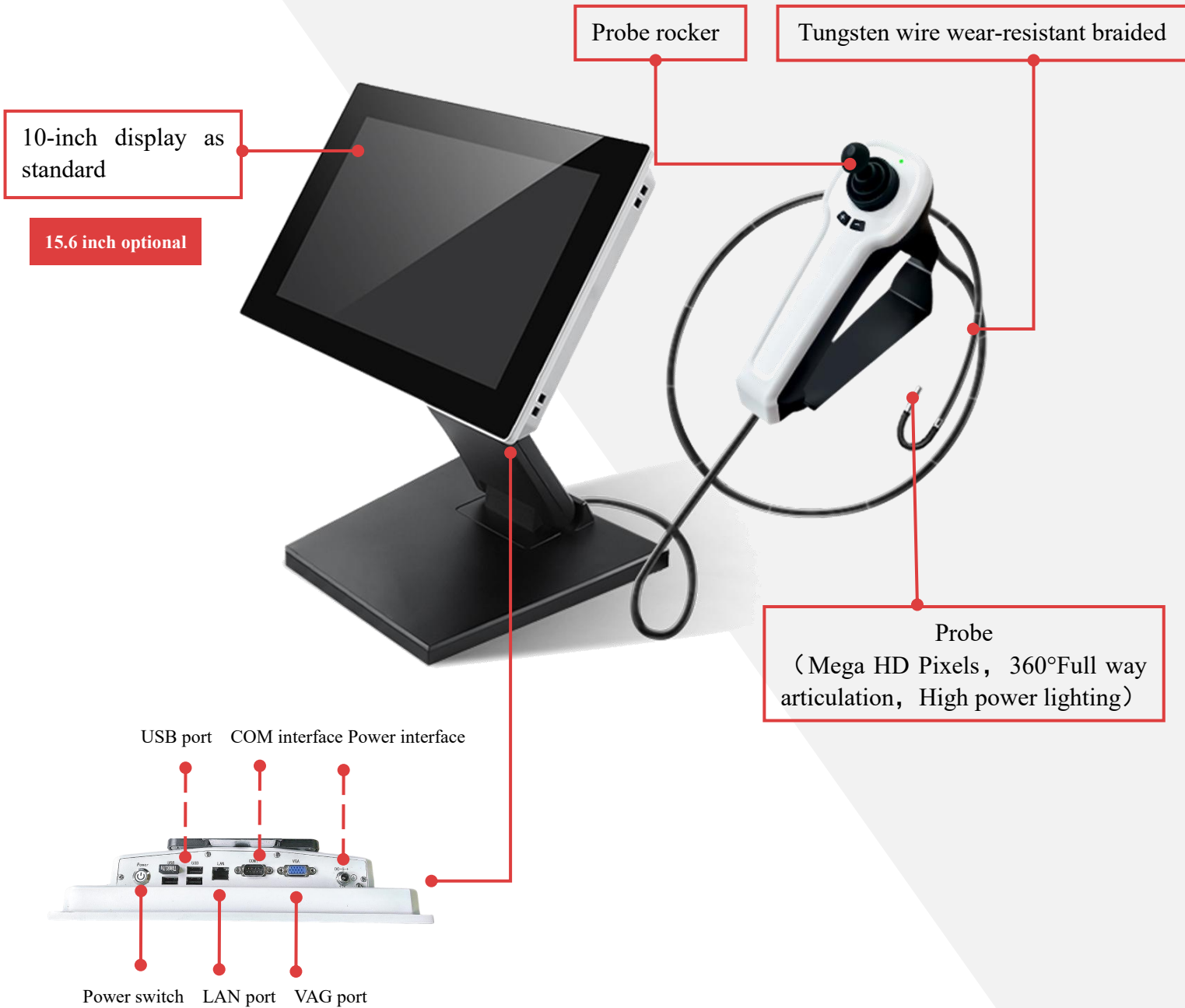

Professional endoscope solution supplier

To be as your wish

More efficient detection

VS-H series online video industrial endoscope, the inserting tube is precisely woven with four-layer tungsten wire, which can be used in various precision casting inspection scene.

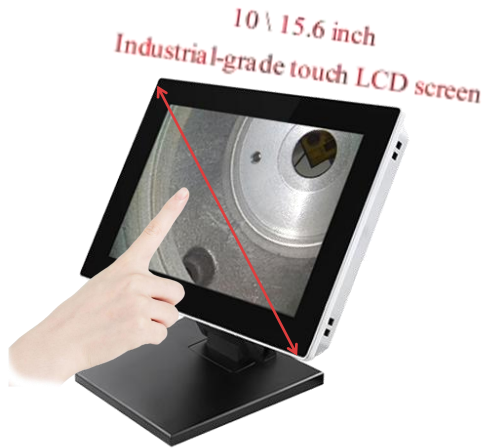

10/15.6 inch HD full touch display

Multiple ways to choose **Wall Mounted Host**
Adjustable angle, can be flipped at will



Desktop Host/Wall Mount



Quickly replace various types of different diameter pipelines

1.8mm-8mm Multiple diameter pipelines



One host can be matched with various specifications of pipelines

Various pipeline options

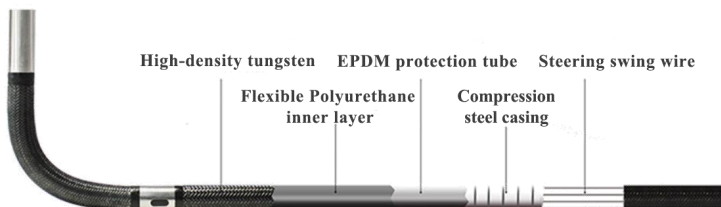

Woven with tungsten wire, more durable



Can carry comparative measurement







Host	Display Screen	10 inch \ 15.6 inch Industrial-grade touch LCD screen
	Output port	VAG video output, USB output
	Storage	Additional 32G U disk, maximum expandable 1T
	Power	Connect the power to use
	Working temperature	-20°C~70°C, Low temperature without preheating(customized-40°C~85°C)
	Storage temperature	-20°C~70°C
	Relative humidity	Max 95%, No condensation
System	Operation System	Windows operating system
	File Format	Image JPEG (JPG)Format, Video:AVI
	File management	Support file and folder creation、Rename in Chinese and English、move、delete, save to USB and copy
	Image Processing	Photo, video, negative, flip, zoom, freeze, online editing, doodle, postmark
	Support Language	Chinese (Simplified and Traditional), French, English, German, Spanish, Italian, Japanese
Packing case	Weight	
	L*W*H	

Camera and Probe

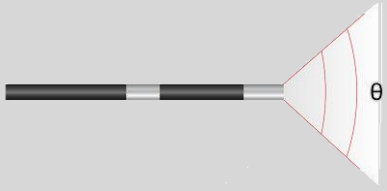
VS-H series are available in various lengths and diameters
You can choose and replace the pipeline according to the actual inspection situation

Model		VS-H20		
		VS-H2010	VS-H2020	VS-H2030
Lens	Direction	Direct view		
	View angle(θ)	120°		
	DOF	3mm~70mm		
	Pixel	160000		
	Illuminating system	LED Integrated lighting		
Probe	Length(L)	5±0.5mm		
	Diameter(D)	2.0mm		
	Articulating	360° full way articulation		
	Bending Angle(α)	≥120°		
	Brightness of Illumination	3900Lux		
	Working temperature	-20°C~70°C		
Inserting tube	Length	1m	2m	3m
	Material	Flexible (tungsten braided tube)		

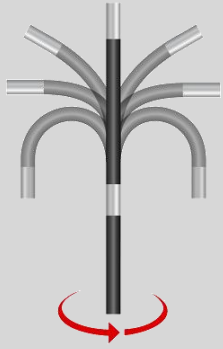
Annotation

VS-H (Direct view)	
Lens direction	
View angle(θ)	
DOF	
Probe Length(L)	
Probe diameter(D)	
360°articulation	
Bend angle(α)	

Packing list

No	Name	PCS	Unit	Photos
1	Host	1	pcs	
2	Insert tube	1	pcs	
3	USB cable	1	pcs	
4	Packing Cast	1	pcs	
5	Adaptor	1	pcs	
6	Warranty card	1	pcs	
7	User manual	1	pcs	
8	Guarantee Card	1	pcs	