

## VS-H45 series industrial endoscope product specification

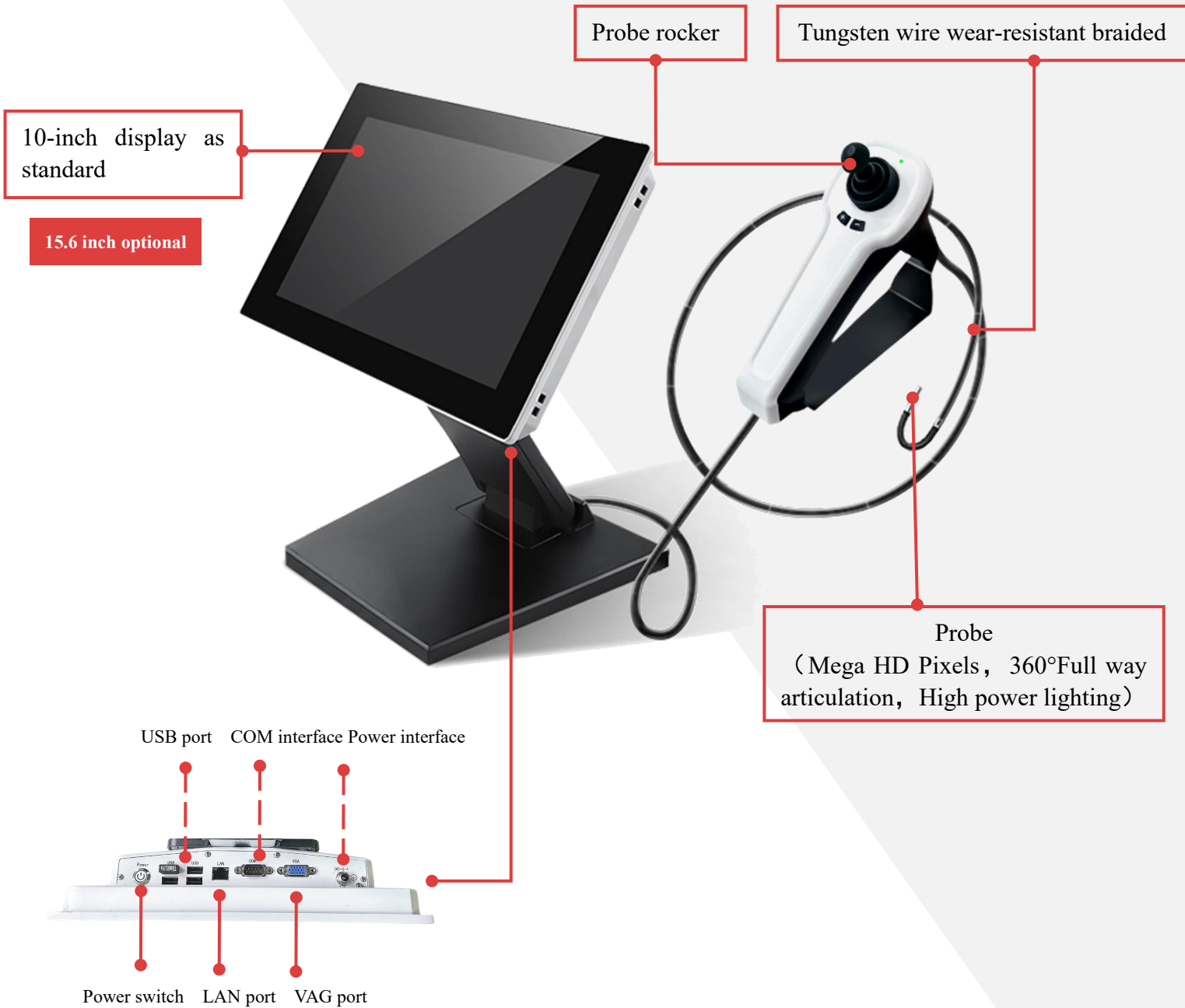

**Professional endoscope solution supplier**

To be as your wish

More efficient detection

VS-H series online video industrial endoscope, the inserting tube is precisely woven with four-layer tungsten wire, which can be used in various precision casting inspection scene.

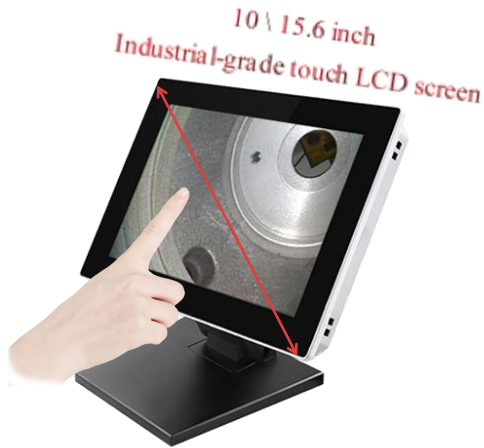

10/15.6 inch HD full touch display

Multiple ways to choose **Wall Mounted Host**  
Adjustable angle, can be flipped at will



Desktop Host/Wall Mount



Quickly replace various types of different diameter pipelines

1.8mm-8mm Multiple diameter pipelines



One host can be matched with various specifications of pipelines

Various pipeline options

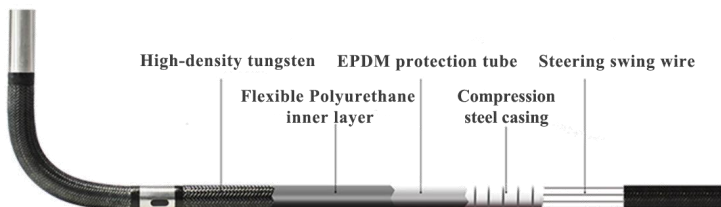

Woven with tungsten wire, more durable







Can carry comparative measurement

<b>Host</b>	Display Screen	10 inch \ 15.6 inch Industrial-grade touch LCD screen
	Output port	VAG video output, USB output
	Storage	Additional 32G U disk, maximum expandable 1T
	Power	Connect the power to use
	Working temperature	-20°C~70°C, Low temperature without preheating(customized-40°C~85°C)
	Storage temperature	-20°C~70°C
	Relative humidity	Max 95%, No condensation
<b>System</b>	Operation System	Windows operating system
	File Format	Image JPEG (JPG)Format, Video:AVI
	File management	Support file and folder creation, Rename in Chinese and English, move, delete, save to USB and copy
	Image Processing	Photo, video, negative, flip, zoom, freeze, online editing, doodle, postmark
	Support Language	Chinese (Simplified and Traditional), French, English, German, Spanish, Italian, Japanese
<b>Packing case</b>	Weight	
	L*W*H	

## Camera and Probe

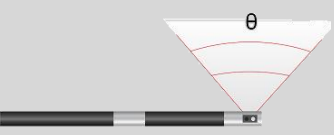
VS-H series are available in various lengths and diameters  
You can choose and replace the pipeline according to the actual inspection situation

Model		VS-HC45					
		VS-HC4510	VS-HC4520	VS-HC4530	VS-HC4540	VS-HC4550	VS-HC4560
<b>Lens</b>	Direction	Side view					
	View of angle( $\theta$ )	120°					
	Depth of field (DOF)	8mm~150mm					
	Pixel	1000000					
	Illuminating system	Rear high-power LED fiber optic transmission					
<b>Probe</b>	Length(L)	13±0.5mm					
	Diameter(D)	4.5mm					
	Articulating	360°full direction articulation					
	Bending Angle( $\alpha$ )	170°±10°		130°±10°	110°±10°	90°±10°	60°±10°
	Protection grade	IP67					
	Working temperature	-20°C~70°C					
<b>Insert Tube</b>	Length	1m	2m	3m	4m	5m	6m
	Material	Flexible (tungsten braided tube)					

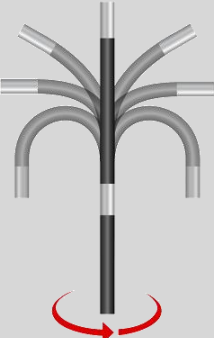
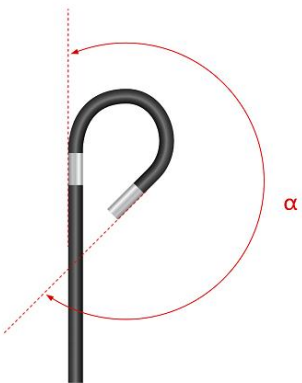
VS-HC (Side View)	
Lens direction	
View angle( $\theta$ )	
DOF	
Probe Length (L)	
Probe Diameter(D)	
360°articulation	
Bending angle( $\alpha$ )	

## Packing list

No	Name	PCS	Unit	Photos
1	Host	1	pcs	
2	Insert tube	1	pcs	
3	USB cable	1	pcs	
4	Packing Cast	1	pcs	
5	Adaptor	1	pcs	
6	Warranty card	1	pcs	
7	User manual	1	pcs	
8	Guarantee Card	1	pcs	